

tiki

Breathing Face Protection

REV L. P/N: 1072-01
EN (CE)



ENGLISH



English Manual

Fig. 1

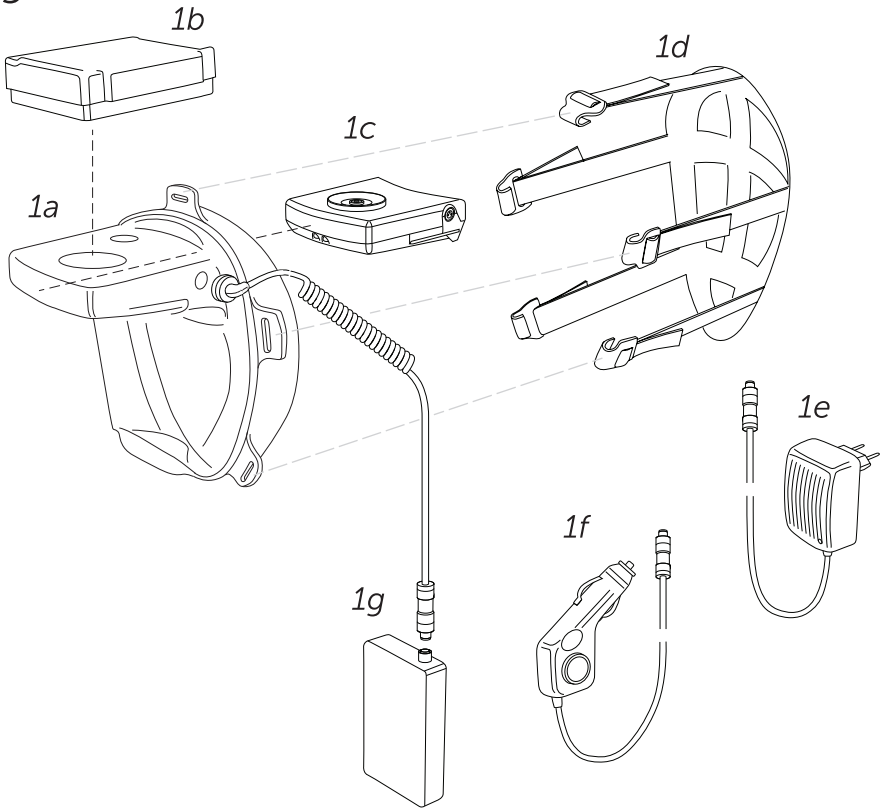

Fig. 2

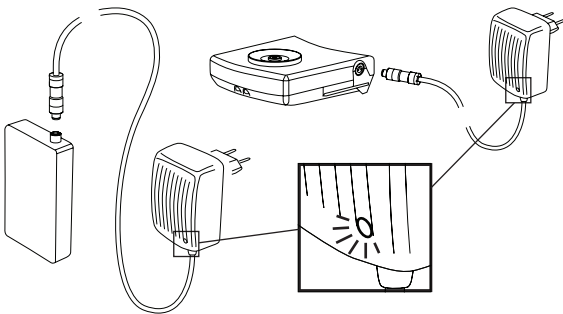

Fig. 3

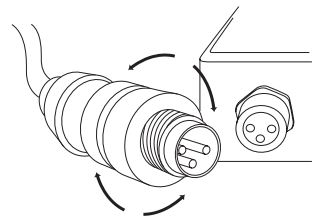

Fig. 4

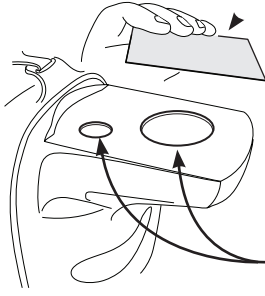

Fig. 5

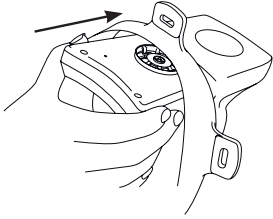

Fig. 6

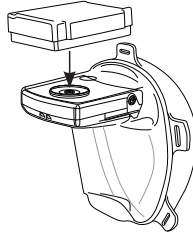

Fig. 7

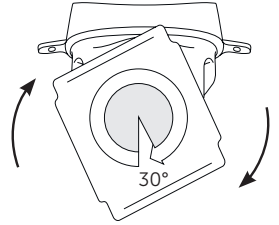

Fig. 8

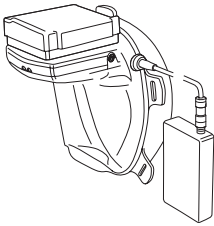

Fig. 9



Fig. 10

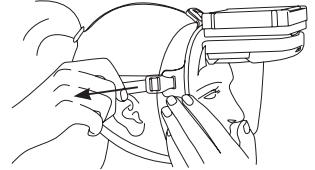

Fig. 11

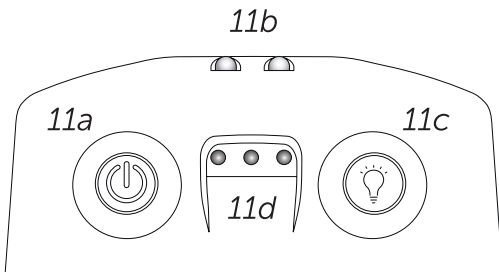
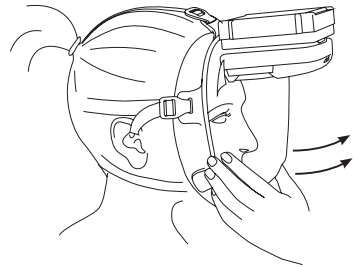

Fig. 12



Contents

1. Important Safety Information
2. Components
3. Initial Use and Charging
4. Seal Check and Fit Testing
5. Operating Instructions
6. Warning System Check
7. Changing Mask and Filter
8. Cleaning and Care
9. Storage
10. How to Read the QR Code
11. Recycling
12. Data and Product Specifications
13. Product Warranty
14. Copyright Notice and Disclaimer
15. Statutory Stipulations and Regulations
16. Icons Glossary

Before any person uses this product, it is a requirement that they have read and fully understand this instruction manual in its entirety.

The Tiki is a full-face respirator for use in environments that may require filtered air. It helps protect the user from certain airborne contaminants if used correctly. Failure to understand the function and limitations of this product can result in injury or death.

Any persons using this type of safety equipment must have undergone appropriate health and safety training for the environment it is used in.

This manual may change at any time. The latest version is available for download at www.tikisafety.com. Ensure you keep the latest version of the manual on hand for reference.

This product helps protect against certain airborne particles. **Misuse may result in sickness or death.**

It is always recommended to complete a Tiki Training and Fitting Test with an authorized Tiki reseller.

1. Important Safety Information

Please read this information carefully before referring to the operating instructions.

The unit should be fitted to the users face to create the tightest seal possible but not to the point causing discomfort for the user. This is to ensure the automatic air demand system works properly to provide positive pressure in the mask.

When purchasing the Tiki as a package, it includes only a P3 particle filter. Please note that this filter (like all filters) has limitations to its use and the environments that it can be used in. The Tiki does not supply oxygen and must not be used in atmospheres having less than 19.5% oxygen content.

It is recommended that the user has had adequate information and training in the use of protective measures to control exposure to hazardous substances. Users of respiratory protective equipment must be fully trained in fitting, wearing, use, care and limitations of the equipment.

Instructions relating to the use of this face mask must be followed at all times. Incorrect usage will result in reduced protection for the user and misuse will void any warranties.

Seal check and fit testing: An improper face seal may allow hazardous particles to enter the mask, reducing or eliminating respiratory protection; thereby putting the user in danger.

In addition, it will also reduce battery time, filter life and may possibly affect the comfort for the user.

Always ensure the mask has a good seal against the users face. Things like facial hair and spectacles may affect seal quality. Please see "Seal check and fit testing" for instructions on how to do this. The seal must be tested before every use.

Do not use the Tiki in an emergency/rescue situation unless you have received proper training in its use, have read and understood this instruction manual and demonstrated proficiency.

Special attention must be given to:

- Face seal
- Warning systems check before each use
- Awareness to different filter and battery durations in different conditions
- Emergency situations
- Procedure at low airflow or warning signals given by the Tiki

WARNING

LEAVE CONTAMINATED AREA IMMEDIATELY IF:

- An emergency occurs and you cannot assist without putting yourself in harm's way.
- Breathing becomes difficult or throat becomes irritated.
- Dizziness or other distress becomes apparent.
- Any component of the respirator becomes damaged.
- Battery is low.
- If you can smell or taste contaminants.
- Airflow to the mask decreases or stops.

Failure to comply with all of (but not limited to) these points can result in respiratory injury or death for the user and may have serious consequences for people or items around you should an emergency situation occur.

2. Components

The Tiki is a powered air purifying respirator (PAPR) that uses filters to remove harmful airborne contaminants. It is made up of several components. The basic components required for the unit to function are the mask, blower, filter and harness. The external battery pack extends the battery life of the mask and the charger is required to charge both the blower unit and the external battery.

3. Initial Use and Charging

Step 1. Remove all of the parts from the packaging. Ensure that all parts are included and that they are not damaged. Please refer to Chapter 2. "Components".

Step 2. Charge the blower unit with the included battery charger. Then charge the external battery pack (sold separately). It is important that both are charged fully before the unit is used to prevent the batteries from running out prematurely.

Charge the blower and external battery separately.

Charge status light (Fig 2, page 2) RED light = charging GREEN light = fully charged

Detailed view: Connect the plugs by lining up the three pins. Then push the plug in and turn the end of the plug clockwise to secure it in place. (Fig 3, page 2)

WARNING

Please note that if the external battery is left connected to the blower when it is not in use the unit will discharge itself due to the internal charging circuit in the blower. If the battery and the blower are disconnected the unit will remain charged. Never charge the unit in less than 0°C.

Step 3. Remove the harness from its packaging and attach it to the mask. Please see Fig 1 on page 2 for illustration.

Step 4. Perform a "Seal check and fit test" as instructed in Chapter 4 in this instruction manual.

4. Seal Check and Fit Testing

Before each and every use, a seal check and fit test must be performed without the blower and filter assembled with the mask. This is to test that the mask seals properly on the user's face. An improper face seal may allow hazardous particles to enter the mask, reducing or eliminating respiratory protection; thereby putting the user in danger. It will also reduce battery time, filter life and may possibly affect the comfort for the user.

To perform a seal check and fit testing:

For your own safety—it is highly recommended to perform a seal check under the supervision of an authorized Tiki instructor.

1. Attach the straps to the mask.
2. Slide the mask over your head (Fig 9, page 3).
3. Tighten the straps until a comfortable fit is attained (Fig 10, page 3).
4. Place a flat piece of paper on top of the mask making sure it covers both holes (Fig 4, page 3).

WARNING

You will not be able to breathe in while the mask is over your head and the holes are covered. Do not panic. Simply move or let go of the seal check pad so that the holes are no longer covered, or remove the mask from your face.

5. Carefully try to breathe in.

If the seal check and fit test was successful you should not be able to breathe in and the mask will push on to your face when you try to do so. You can now proceed to Operating Instructions in the next chapter.

If the seal check and fit test was not successful, you will notice air leaking into the mask. Try to diagnose where the leak is and try to remedy it. It may only require an adjustment of the straps, or you may be required to use a different sized mask. The masks come in three sizes; small, medium and large. Other things that can corrupt a tight seal around the face may include (but are not limited to) facial hair, head hair, glasses and different physical features.

If the mask continues to leak and you are unable to perform a successful seal and fit test, do not use the mask. Please contact us through our website www.tikisafety.com.

5. Operating Instructions

Step 1. Slide the blower unit inside the top of the mask (Fig 5, page 3). Then attach the filter to the top of the unit (Fig 6, page 3), make sure filter and blower coupling connects by 30° and twist. (Fig 7, page 3).

Note! The filter label has arrows pointing toward where your face will be once the mask is on.

WARNING

Attaching the filter the wrong way will cause the pressure sensor to malfunction and will put the user in danger.

Step 2. Reset function

Each time you start using your Tiki you should reset the blower unit. This action is to ensure the software is reset and good to go. (Fig 11, page 3). Reset the blower unit by holding it upside-down (with the buttons facing up). Start by pressing the light-button first (Fig 11c, page 3), then press down the on/off-button (Fig 11a, page 3). Hold down both buttons until both right red LEDs light up and the right has flashed (Fig 11d, page 3) ● ○ ☀. The blower should not start up. Release the buttons. Reset is complete. You may now start using the blower unit.

Step 3. When using the external battery pack, attach the external battery to the Tiki before you slide the unit over your head.



Step 4. Tighten the straps until a comfortable fit is accomplished, making sure there is nothing obscuring the seal around the face such as hair or glasses that may cause leaks. If the mask does not seal properly and there is a leak, contaminated air may enter the mask exposing the user to the contaminant. This may also greatly reduce the battery and filter life—putting the user in danger.



Step 5. Switch the unit on by holding down the power button for 3 seconds. (Fig 11a, page 3)

The blower unit should temporarily increase in speed until the unit can establish that the pressure inside the mask is positive. After a few seconds the fan inside the blower unit will slow down as it optimises the airflow to the required amount. The airflow will now continue to be adjusted automatically according to use e.g. if you start breathing faster the fan will speed up increasing the airflow so as to keep positive air pressure in the mask at all times. This is to minimise the wear on the filter and the battery; and for the comfort for the user.

The button marked "Light on/off" is to switch on and off the built in LED work lights (Fig 11b, page 3). Using the light will reduce the battery time of the blower unit marginally.

Red indicator lights (Fig 11d, page 3)

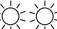

  The left light indicates if the blower unit is on or off. It will always be lit as long as the unit is on.

   When only the right light flashes and the blower emits an audible alarm every 5 seconds, the battery power is low and there is roughly 15 minutes battery power left. Remove yourself from the contaminated area immediately and charge the blower unit and the external battery back to 100%.

  If the two lights to the right start flashing and the blower emits an audible alarm every (one) second; this indicates that the mask filter is either blocked or there is a major leak causing negative pressure in the mask. This means the user may be exposed to the external atmosphere. Remove yourself from the contaminated area immediately and charge the blower unit and the external battery back to 100%.

Step 6. Attach the battery pack securely onto clothing or helmet. E.g. in your front shirt pocket or onto belt utilising the clip on the battery pack. We also recommend you secure the cable so that there is no chance it will be caught on anything.

Symbols for red LEDs (fig 11, page 3)

-  = off
-  = on
-  = flashing

6. Warning System Check

A warning system check must be performed before each and every use.

If a major leak is detected causing a loss of positive pressure in the mask, an audible alarm will sound 2 seconds after the leak is detected, alerting the user of the leak. Therefore to test that the warning system is functioning, the user need only manually cause a leak. This can be done by simply pulling the mask away from the face a couple of centimeters (Fig 12, page 3) until the warning alarm sounds. Once this sounds the user can put the mask back on their face; the alarm should stop and normal operation can proceed.



WARNING

The warning systems check must be done before each use and only be performed in a non hazardous environment.

7. Changing the Mask and Filter

Step 1. Remove the filter by twisting it 30° anti-clockwise.

Step 2. Remove the blower by gently sliding in your index finger between the blower and the top of the mask. Grab the blower unit with your thumb and index finger and pull gently. The blower should slide out. If it does not, insert your index finger further, separating the blower from the mask more and pull again.

Step 3. Dispose mask and/or filter. Please consider the environment and dispose these parts as plastic recyclables*.

Step 4. Remove new mask/filter from the packaging.

Step 5. Attach the straps if they are not already attached.

Step 6. Insert the blower unit according to illustrations for 'Initial use' in this manual (Fig 5, page 3).

Step 7. Attach filter to the blower unit (Fig 6, page 3) by twisting it 30° clockwise (Fig 7, page 3).

WARNING

If the outside of the Tiki has been exposed to pathogens it may need to be disinfected or sterilised. Take care not to contaminate the blower unit.

*If the device was used in a hazardous environment there may be hazardous particles on the mask and in the filter. It may need to be disposed of as hazardous goods. Please dispose of according to local, state and federal laws.

8. Cleaning and Care

The Tiki has been designed to be used for a long time. If the mask is contaminated it can be cleaned and disinfected and put to use again. If it is damaged it should be recycled. If it is contaminated beyond restoration it should be disposed of.

- Clean the Tiki using a cloth with a mixture of water and mild detergent. Do not use any solvents. During cleaning ensure that no water is allowed to enter the blower unit. The blower unit should never be immersed in fluid.
- Use a disinfecting spray like Incidur®(Ecolab® Healthcare) on the outside of the blower unit to remove bacteria and germs.
- Dry the Tiki with a cloth and/or leave it to dry in the open air.

WARNING

- Do not open the blower unit and never modify or alter this product as this will void any warranties.

9. Storage

To maintain the integrity of the batteries (both the internal battery in the blower unit and the external battery pack), please follow the guidelines below when storing your device.

Long term storage (>6 months).....	17°C to 28°C at <60% RH
Medium term storage (<3 months).....	0°C to 38°C
Short term storage (<1 month).....	-20°C to 40°C at <30% RH

10. How to Read the QR Code

Tiki Safety products have a QR code that can be easily read by most smartphones that have a QR code reader application installed. The QR code contains the serial number information about your Tiki Safety product: There are two types of serial numbers on Tiki Safety's products.

Version 1: PN105202D2005B01 where PN stands for "Part Number", D for "Date", B for "Batch number".
Information: TikiSTART Medium manufactured year 20 month 05 with batch number 01.

Version 2: PN105202D20S0001 where PN stands for "Part Number", D for "Date", S for "Serial number".
Information: TikiSTART Medium manufactured year 20, followed by a four digit consecutive number 0001.

11. Recycling

The mask is composed of PET and TPE materials, and is recycled according to local ordinances. When this should be done can be determined by either a regular system check of the mask and/or a disposal schedule. If the device was used in a hazardous environment there may be hazardous particles on the mask. It may need to be disposed of as hazardous goods. Please dispose of according to local, state and federal laws.

The P3 particle filter is composed of ABS plastic and HEPA fibreglass media. Please note that depending on the environment it has been used in, it can contain dangerous particles and will therefore have to be disposed of according to local ordinances and regulations.

The blower unit and external battery both contain electrical equipment and a lithium polymer battery. These should be recycled or disposed of according to local regulations.

12. Data and Product Specifications

The Tiki is a positive pressure variable airflow purifying respirator that adjusts airflow according to demand. It is designed to be used in an environment that has normal oxygen content for breathing and no chemicals or particles requiring special filters.

The Tiki unit consists of:

Face mask (Fig 1a, page 2)

Small, medium and large. The mask should be disposed of if contaminated. The mask is composed of PET and TPE.

Harness (Fig 1d, page 2)

The harness is made from elastic webbing and nylon clips. This can be reused unless it is exposed in hazardous environments, to contagious pathogens or other harmful particles.

Blower unit (Fig 1c, page 2)

The blower contains the fan, the work lights and the operational buttons and warnings. It automatically adjusts airflow according to demand inside the mask. The blower contains a lithium polymer battery that will run the blower for a minimum of 60 minutes.

P3 particle filter (Fig 1b, page 2)

When purchased, the Tiki includes only a particle filter and should not be used in areas that contain gaseous solvents and other hazardous airborne contagions that a P3 particle filter will not remove. The particle filter is composed of ABS plastics and HEPA fibreglass media.

Battery charger (Fig 1e, page 2)

The battery charger is for charging the blower unit and the external battery pack. These must be charged separately. Never charge batteries when the battery temperature is less than 0°C.

External battery pack (Sold separately) (Fig 1g, page 2)

The external battery is a clip-on unit containing a lithium polymer battery. It connects to the blower unit using a cable with a screw fitting. This will increase the battery life for a minimum of 6 hours*. Battery cable is included. (*Provided the seal check and fit testing has been performed successfully. Test conducted at 20x1.5L/min sinusoidal).

Unit operational temperature -10°C to 45°C. Charging temperature 5°C to 30°C.

Do not operate if more than 90% relative humidity.

Approval: EN 12942 TM3P R SL, CE 0158

WARNING

Do not use the Tiki in explosive environments. Use only accessories manufactured by Tiki Safety AB.

Batteries:

The blower unit and the external battery pack both contain lithium polymer batteries. It is therefore necessary that the following precautions be followed:

- Do not dispose of in fire or subject to extreme heat.
- Do not disassemble.
- Do not use if there is any sign of mechanical damage.
- Do not use in heavy rain or submerge them in liquid.
- Do not charge in less than 0°C.

In the unlikely event that the batteries are damaged and electrolyte seeps out, keep away from eyes. If electrolyte comes in contact with eyes, flush with water and seek medical attention immediately.

Battery warning time	>15 min (normal conditions)
Minimum free-flow air	200L/min
Minimum filter free-flow	100L/min
Pressure trigger	≤2 millibar
Pressure alarm	>2 seconds negative pressure
Battery charge specification	Input 100-240V AC Output 2A
Mask weight	Small 92g, Medium 102g, Large 112g
Blower	165g
Filter	70g
Harness	33g
External battery	200g
Battery cable	48g
Total weight (Less external battery kit)	Small 360g, Medium 370g, Large 380g
Tiki Products	
Product name:	Part number:
TikiSTART Starter Pack, small mask	1050-51
TikiSTART Starter Pack, medium mask	1050-52
TikiSTART Starter Pack, large mask	1050-53
Tiki Mask 5 Pack, small	1010-51
Tiki Mask 5 Pack, medium	1010-52
Tiki Mask 5 Pack, large	1010-53
P3 Particle Filter, 2 pcs	1005-51
P3 Particle Filter, 120 pcs	1005-52
P3 Particle Filter, 60x2 pcs	1005-53
External Battery Pack	1007-51
Universal Car Charger 12-24V	1080-51
Harness, 5 pcs	1012-51

13. Product Warranty

LIMITED WARRANTY

This product has been manufactured and tested to the highest quality standards by Tiki Safety AB. This Limited Warranty offered by Tiki Safety AB covers defects in material or workmanship in Tiki Safety AB products that have met the following conditions and that are within the warranty period.

This warranty extends to the original purchaser only and is non-transferable. Only consumers purchasing Tiki Safety AB products from authorised Tiki Safety AB retailers or resellers or through Tiki Safety AB may obtain coverage under this limited warranty.

Tiki Safety AB warrants this product against defects in material or workmanship as follows:

Tiki Safety AB will replace at no charge for parts only or, at its option, replace any product or part of the product that proves defective due to improper workmanship and/or material, under normal installation, use, service and maintenance.

If Tiki Safety AB is unable to provide a replacement and repair is not practical or cannot be made in a timely fashion, Tiki Safety AB may elect to refund the purchase price in exchange for the return of the product.

The standard warranty period is 1 year or 2000 hours from original date of purchase from Tiki Safety AB or authorized reseller. This excludes consumables like filter and mask. Warranty period may vary depending on local law where the product was originally purchased.

The warranty does not cover any problem that is caused by (but not limited to):

- A. Conditions, malfunctions or damage not resulting from defects in material or workmanship.
- B. Conditions, malfunctions or damage resulting from normal wear and tear, improper installation, improper maintenance, misuse, abuse, negligence, accident or alteration.
- C. Accessories, connected materials and products, or related products not manufactured by Tiki Safety AB.

This limited warranty is void if a product is returned with removed, damaged or tampered labels or any alterations (including removal of any component or external cover).

Tiki Safety AB will not provide any warranty coverage unless claims are made in compliance with all terms of the controlling warranty statement included with your product and the proper return procedure is followed.

To request warranty service, you will need to provide:

1. The sales receipt or other evidence of the date and place of purchase.
2. A description of the problem.
3. Delivery of the product or the defective part, postage prepaid and carefully packed, insured and with tracking.

When warranty service is completed, any repaired or replacement product or part will be returned to you postage prepaid.

It is a requirement that you contact the customer Service Department and provide information related to the problem before attempting to return the product. For details on how to contact the service department, please go to www.tikisafety.com.

REPAIR OR REPLACEMENT (OR, IN LIMITED CIRCUMSTANCES, REFUND OF THE PURCHASE PRICE) AS PROVIDED UNDER THIS WARRANTY IS THE EXCLUSIVE REMEDY OF THE PURCHASER. TIKI SAFETY AB NEITHER ASSUMES NOR AUTHORIZES ANY PERSON TO CREATE FOR IT ANY OTHER OBLIGATION OR LIABILITY IN CONNECTION WITH THIS PRODUCT.

TIKI SAFETY AB SHALL NOT BE LIABLE TO PURCHASER OR ANY OTHER PERSON FOR ANY INCIDENTAL, SPECIAL OR CONSEQUENTIAL DAMAGES, ARISING OUT OF BREACH OF THIS WARRANTY OR ANY IMPLIED WARRANTY (INCLUDING BUT NOT LIMITED TO ANY IMPLIED WARRANTY OF MERCHANTABILITY).

14. Copyright Notice and Disclaimer

Tiki Safety AB makes no representations or warranties with respect to the contents hereof. In addition, information contained herein are subject to change without notice. Every precaution has been taken in the preparation of this manual. Nevertheless, Tiki Safety AB assumes no responsibility for errors or omissions or any damages resulting from the use of the information contained in this publication. Any times/measurements in this manual are taken under optimal conditions. Charging times and operational times may vary depending on temperature, filter type, amount of particles in the air, heavy breathing etc.

All rights reserved. No parts of this manual may be reproduced in any form without the express written permission of Tiki Safety AB.

All illustrations and text in this user manual are subject to copyright ©2014.

All products are patented worldwide. Pat.No. D755953

15. Statutory Stipulations and Regulations

European directive for personal protection devices (89/686/EC)

Standard EN 12942:1998+A1:2002+A2:2008: Respiratory protective devices - Powered filtering protective devices incorporating a helmet or hood.

System approval by:

DEKRA EXAM GmbH Personal Protective Equipment,
Gas Measuring Equipment Adlerstr. 29 * 45307 Essen

Certification body mark on the system:

DEKRA EXAM GmbH Zertifizierungsstelle,
Dinnendahlstraße 9 * 44809 Bochum

Declaration of Conformity and other documents can be downloaded from our webpage at tikisafety.com

16. Icons Glossary



For your safety do not store this product where the humidity (RH) is above 60%.



Storage temperature should not be below -20°C or above 40°C. Recommended temperature for long term storage should be approximately 21°C.



Read the instructions manual to get all the information you need in order to handle and/or wear the product correctly.



This product is disposable and should be recycled if not contaminated.



This product is CE approved.



MADE IN SWEDEN

Developed and patented by:
Tiki Safety AB

Tiki Breathing Face Protection
www.tikisafety.com
Pat.No. D755953

Printed in Sweden. All rights reserved Tiki Safety AB ©2019.